

K9DACTED

**State of Arizona
Department of Liquor Licenses and Control**

Created 08/12/2020 @ 11:33:49 AM

Local Governing Body Report

LICENSE

Number: Type: 012 RESTAURANT
Name: MOMO BOWL
State: Pending
Issue Date: Expiration Date:
Original Issue Date:
Location: 725 W APACHE TRAIL
#27
APACHE JUNCTION, AZ 85120
USA
Mailing Address: 1881 W FOOTHILL STREET
APACHE JUNCTION, AZ 85120
USA
Phone: (480)983-0707
Alt. Phone: (480)650-8975
Email: MOMOBOWL2017@GMAIL.COM

AGENT

Name: ROBERT STEWARD
Gender: Male
Correspondence Address: 1881 W FOOTHILL STREET
APACHE JUNCTION, AZ 85120
USA
Phone: (480)650-8975
Alt. Phone:
Email: MOMOBOWL2017@GMAIL.COM

OWNER

Name: MOMO BOWL LLC
Contact Name: ROBERT STEWARD
Type: LIMITED LIABILITY COMPANY
AZ CC File Number: L20626478 State of Incorporation: AZ
Incorporation Date: 04/18/2016
Correspondence Address: 1881 W FOOTHILL STREET
APACHE JUNCTION, AZ 85120
USA
Phone: (480)650-8975
Alt. Phone:
Email: MOMOBOWL2017@GMAIL.COM

Officers / Stockholders

RECEIVED
CITY CLERK DEPT.
2020 AUG 18 AM 10:36
CITY OF APACHE JUNCTION

Name:
MASAE ATHENA STEWARD

Title:
MEMBER

% Interest:
100.00

MOMO BOWL LLC - MEMBER

Name: MASAE ATHENA STEWARD
Gender: Female
Correspondence Address: 1881 W FOOTHILL STREET
APACHE JUNCTION, AZ 85120
USA
Phone: (480)650-8975
Alt. Phone:
Email: MOMOBOWL2017@GMAIL.COM

<h3>MANAGERS</h3>

Name: SHUN STEWARD
Gender: Male
Correspondence Address: 1881 W FOOTHILL STREET
APACHE JUNCTION, AZ 85120
USA
Phone: (480)227-0738
Alt. Phone:
Email: SHUNSHINE1998@GMAIL.COM

APPLICATION INFORMATION

Application Number: 117129
Application Type: New Application
Created Date: 08/12/2020 *Selena*

QUESTIONS & ANSWERS

012 Restaurant

- 1) Are you applying for an Interim Permit (INP)?
No
- 2) Are you one of the following? Please indicate below.
Property Tenant
Subtenant
Property Owner
Property Purchaser
Property Management Company
PROPERTY TENANT
- 3) Is there a penalty if lease is not fulfilled?
No
- 4) Is the Business located within the incorporated limits of the city or town of which it is located?
Yes
- 5) What is the total money borrowed for the business not including the lease?
Please list each amount owed to lenders/individuals.
\$45,000
LENDING CLUB \$30,000 595 MARKET ST #200 SAN FRANCISCO CA 94105
WELLS FARGO \$8000 420 MONTGOMERY ST SAN FRANCISCO CA 94104
AMERICAN EXPRESS \$6000 PO BOX 30384 SALT LAKE CITY UTAH 84130
FIRST NATIONAL BANK OF OMAHA \$1000 1620 DODGE ST OMAHA NEBRASKA 68197
- 6) Is there a drive through window on the premises?
No
- 7) If there is a patio please indicate contiguous or non-contiguous within 30 feet.
NONE
- 8) Is your licensed premises now closed due to construction, renovation or redesign or rebuild?
No

20 AUG 12 Liq. Lic. RM1025

N

60ft

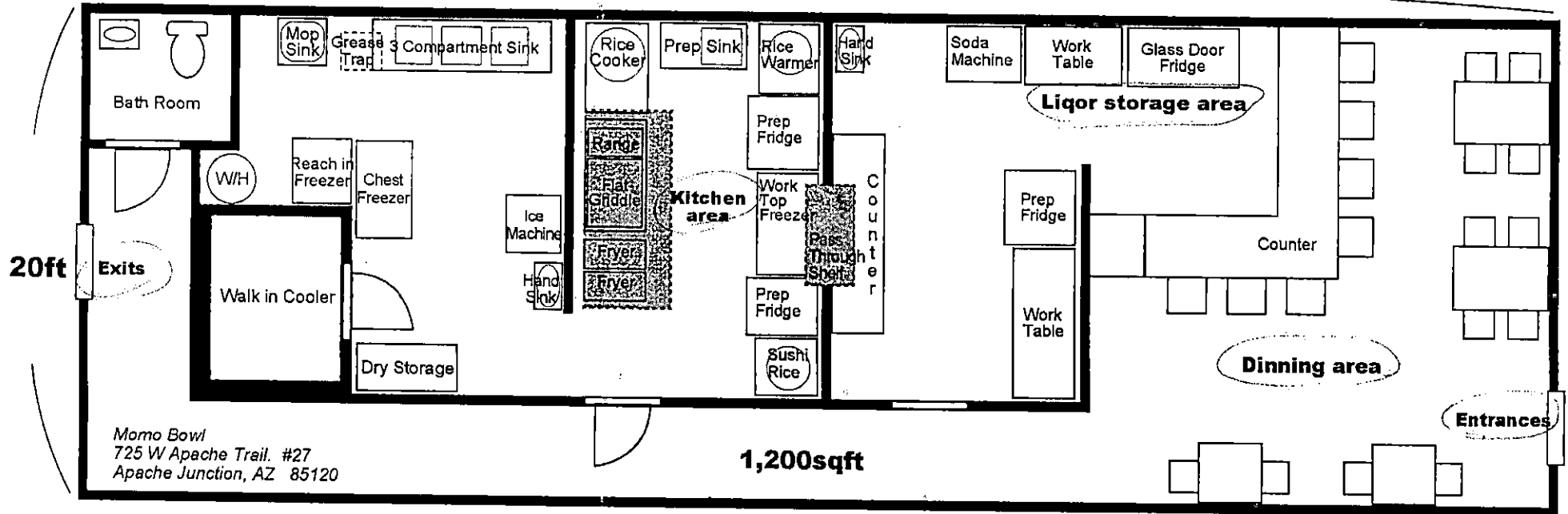

S

AMENDMENT

20 AUG 12 Liq. Lic. RM1143